

1. Ceiling and luminaire connection

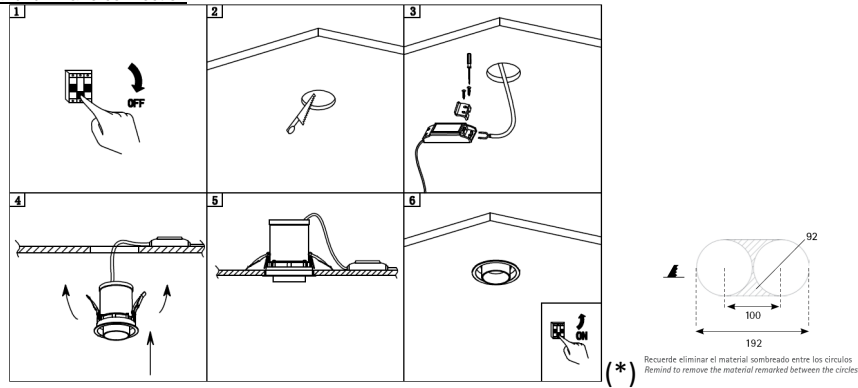

(Figure 1)

(2.7)=2700K; (3)=3000K; (4)=4000K

REFERENCE	POWER (W)	LUMENS (lm)	OPENING	IP DEGREE	DIMENSIONS (mm)	CUT (mm)
59314	14	870(2.7)/915(3)/960(4)	38°	23	Ø100*H117	Ø92
59528	28	1740(2.7)/1830(3)/1920(4)	38°	23	200*100*H117	192*92 (*)

Note: The IP value refers to the external value. The internal IP index of the products are 20. Additional information can be checked in the product data sheet.

The connection block is not supplied with the luminaire.

The authorized electrician will have to make the electrical connection by using a connection block, with two screws with phase + neutral, 1,5mm²/10A/250V capacity and IP degree adequate to the luminaire marking, which meets EN 60998, or, if it is possible due to the driver features, directly to the driver with wiring (Blue=N and Brown=L) class II adequate in order to maintain the the isolation class.

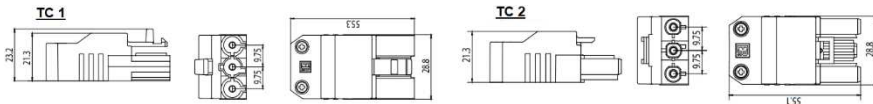

(Figure 2)

⚠ Warnings

- Please, read and keep, in safe place, the installation instructions before starting the installation of the product.
- Cut the main power supply before starting the installation works.
- The light source of this luminaire is NOT REMOVABLE, when the light source reaches the end of its life, the complete lamp must be replaced.
- The installation must be carried out by qualified personnel.
- Improper handling of the components or the luminaire itself could damage the correct functioning of this product, thus voiding the manufacturer's warranty.
- Luminaire suitable only to be used indoor.
- If the luminaire connections are damaged, the replacement must be done by JISO ILUMINACIÓN, SL. or by an authorized electrician with the approval of JISO ILUMINACIÓN, SL.
- It is recommended to install in a minimum cavity that is 5cm more than the height of the luminaire.
- It is recommended a 10cm distance between driver and luminaire.
- DO NOT place the driver or converter over the luminaire.
- JISO ILUMINACIÓN is not responsible for the improper use or modifications made to the product.
- The luminaire must not be covered by insulating material or similar under any circumstances.
- DO NOT touch the luminaire when it is on or until a reasonable time has elapsed after it has been switched off.
- DO NOT use aggressive material (solvent type or similar) to clean the luminaire. The surface may be damaged.
- The luminaire is designed to be used, only, connected to a stable power supply network. 220-240 ~ 50 / 60Hz.
- During Step 4 must be avoid to force the clamps more than 180° to avoid damaging the springs.
- Do not mount the luminaire on damp, freshly painted, surfaces or in which electrical conductivity is present.
- When colour temperature of luminaire is 4000K (RG2): "The luminaire should be located to avoid permanent view from a distance shorter than 0,93m"

JISO ILUMINACIÓN, S.L. reserves the right to make technical, formal and dimensional modifications at any time and without prior notice. It is not allow to reproduce totally or partially this document without authorization from JISO ILUMINACIÓN, SL.

JISO ILUMINACIÓN assumes no responsibility for any errors that may appear in this document.



- Do not eliminate with domestic wastes
- Company adhered to ECOEMBES.
- Cumplimiento directiva 2002/95/CE de Restricción de ciertas Sustancias in electrical and electronic equipment.
- Indicates the compliance with low voltage directives.
- Luminarias no adecuadas para cubrirse con material aislante.
- Recessed assembly. Light to be installed on NOT combustible/inflammable surfaces only. EN 60598-1:2008.
- Class II Protection. Double insulation
- Energy efficiency within A and A++.
- Protection index against liquid and solid particles in the external face of the luminaire.
- Color rendering index.
- Luminaire to be used indoor.
- Rotation angle, around central axis.
- Swivelling angle, around central axis.

Check updated information on our website:
www.jisoiluminacion.com